

AQUA FLOW

WWW.AQUACNC.COM



**UNLOCK
GREATER
PRECISION
PRODUCTIVITY**

Aqua Flow is a ISO 9001:2008 certified global precision component manufacturing firm, developing and delivering customized solutions for diverse sectors with industry benchmarked value detailing.



THE AQUA EDGE!



WWW.AQUACNC.COM

"From prototype to process development and through production, With Aquaflow, be assured you're in the most competent, innovative hands in the industry"

Total Project Management

Give Aquaflow your manufacturing challenges, freeing up valuable resources to concentrate on what you do best.

Design, Concurrent and/or Value Engineering

Let our experienced production team work with you to arrive at the most cost-effective Solution.

Supply Chain Management

Aquaflow can offer full traceability and certification of all manufacturing processes through our ISO:9001 accreditation and our network of approved suppliers.

State of the Art Technology

Continuous investment in modern CNC Machine Tools to support contractual requirement, forming dedicated Cells in certain instances, backed up by the latest CAD/CAM systems, ensures your product is manufactured using the latest, most cost effective methods.

4 DECADE OF PRECISION EXPERIENCE

"Aqua Flow is an enviable spectrum in the precision manufacturing space with decades of experience, State of the art technology, coupled with top notch and experienced engineers focused on continuous improvement"

Our mission is to continuously improve and build customer partnerships by delivering best in class production, prototype and precision components supported by industry bench marked standards and values.

"We have the know-how you need and are passionately precise"

WWW.AQUACNC.COM

THE AQUA DIFFERENCE

At Aqua Flow the underlying belief is that Systems, Quality and Safety are to be the center of all operations.

As an organization Aqua Flow is fully committed to ensuring that all our employees are well-trained and adhere to safe working practices.

“WE ARE COMMITTED TO SATISFY OUR CUSTOMERS BY MANUFACTURING & SUPPLYING OF HIGH QUALITY PRODUCTS CONSISTENTLY AND PROVIDING EXCELLENT SERVICE THROUGH CONTINUOUS PROCESS IMPROVEMENTS & EMPLOYEE INVOLVEMENT”

The strength of Aqua Flow is to the fact that both the project management and delivery teams imbibe and demonstrate the vision on every interaction with the customers and stakeholders. At Aqua Flow we strongly trust that adopting such intrinsic values will become a key differentiator in the precision manufacturing space across the globe.

With a quality department structured to systematically maintain Documents for receiving, In-line & final inspection and an integrated ERP to trace export components, lab reports, test sample you can be rest assured that you're in the most competitive and innovative hands in the industry.

Behind our state-of-the-art facilities lies a team of expert technicians and programmers dedicated toward delivering the best possible results.

We constantly work on industrializing the business, including significant equipment purchases certifications and facility upgrades. Significant investments in training and lean initiatives to improve already high quality standards for complex precision machining supporting diverse end markets.



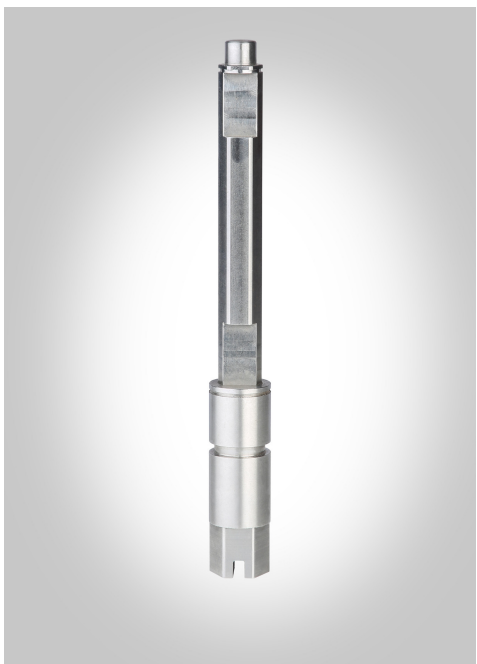

OUR CAPABILITIES

We have machined over 1000 different type of components, designed about 300 varieties of tools and 50 types of injection molded plastic components

INFRASTRUCTURE

Our infrastructure is hugely scalable. With our breadth of manufacturing technology and extensive equipment arsenal, we are equipped to deliver on virtually any scale.

Our facility boasts a range of composite production technologies such as prototyping equipment, machine tooling and fabrication machinery.

SOURCING CAPABILITIES

Forging
Shell Molding
Sand Casting
Investment Casting
Centrifugal Casting
Pressure Die Casting
Gravity Die Casting

IN HOUSE PROCESSES

plastic injection molding
2D and 3D modelling
Machining Simulations
Heat Treatment
Plating



VMC AND HMC CAPABILITIES

MACHINED WITH DOOSAN HMC

TRAVEL DISTANCE (X/Y/Z): 1050X900X1000MM

TABLE SWING: 1050 MM (53.14 INCH)

PALLET SIZE: 635 X 635 MM

SQUARE OUT TOLERANCE: ± 0.005

BORE TOLERANCE: ± 0.005

POSITION TOLERANCE: ± 0.002

MACHINED WITH DOOSAN VMC

TRAVEL DISTANCE (X/Y/Z): 1300/670/1025MM

NIKKEN TABLE FACE PLATE SIZE: DIA 320MM

NIKKEN TABLE SWING: 800MM

HYDRAULIC SUPPORTED - 500KGS

WITHOUT SUPPORT - 300KGS

CONTINUOUS HELICAL MILLING

POSSIBLE WITH MULTI AXIS

MASTER CAM PROGRAMING SOFTWARE



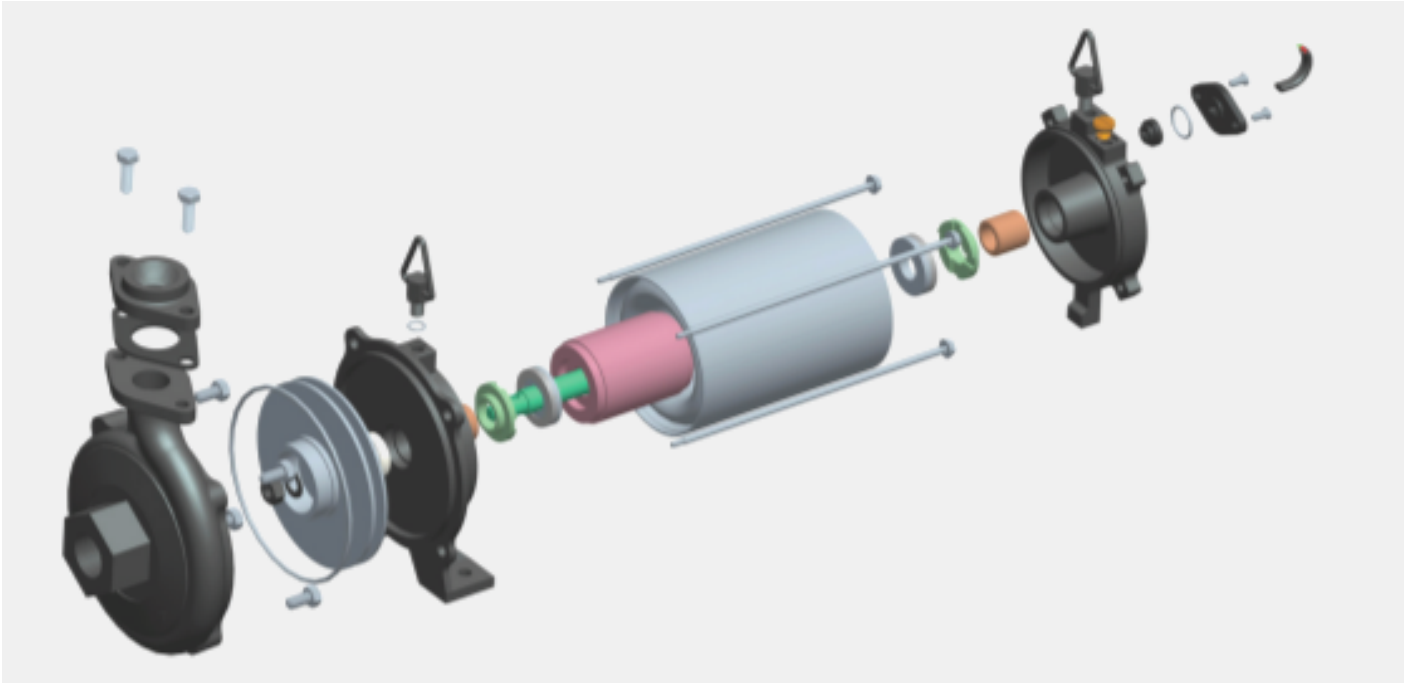

ASSEMBLING & TESTING CAPABILITIES

At Aqua CNC we have a specialized testing unit and testing bays as we understand the significant difference we could make in our production cycle as well as to the customer engagement experience. Our testing set up is capable of testing Vibration, Paint coat, Leak, Pressure and Hydrostatics along with Temperature Monitoring and Record Traceability.

SPECIALIST SHAFT MANUFACTURING



Aqua Flow offers specialized shaft manufacturing to meet your application requirements. We specialize in reducing your cost by providing strategic outsourced manufacturing solutions.

Machined to your requirement with wide range of material choices including carbon steel, medium alloy, stainless steel seamless pipes, nitriding steels and carburising grades.

Includes Turning, Milling, Internal and External Keyways, Spline Cutting, Gear Cutting, Threading, ID/OD Grinding

OUR MACHINERY INVENTORY

TURNING CENTRE		
Si No	Specification	Number of Qty
1	Chuck size : 160mm; Between Centre :250mm	2
2	Chuck size : 200mm; Between Centre : 250mm	2
3	Chuck size : 200mm; Between Centre :300mm	2
4	Chuck size : 200mm; Between Centre :500mm	1
5	Chuck size : 200mm; Between Centre :750mm	1
6	Chuck size : 300mm; Between Centre :300mm	1
7	Chuck size : 300mm; Between Centre : 700mm	2
8	Chuck size : 300mm; Between Centre :1340mm	1
TURN MILL		
9	Chuck size : 200mm; Between Centre : 250mm	1
VERTICAL MACHINING CENTRE		
10	Table Size(XYZ): 1000mm X 580mm X 650mm, 4 th Axis Available : 250kg	1
11	Table Size(XYZ): 1300mm X 660mm X 570mm, 4 th Axis Available: 250kg	1
12	Table Size(XYZ): 660mmX510mmX460mm 4 th Axis Available : No	1
13	Table size(XYZ): 1600mm X 800mm X 800mm 4 th Axis Available : No	1
14	Table size(XYZ): 1150mm X 550mm X 550mm 4 th Axis Available: No	1
15	Travel distance(X/Y/Z): 1250 X 500 X1025mm 4 th axis Loading capacity: 500kg Table Swing : 800mm	1 No Booked
HORIZONTAL MACHINING CENTERS		
16	Travel distance(X/Y/Z) :1050 X 900 X1000mm Table Swing: 1350mm (53.14 Inch) Pallet Size:635 x 635 mm	1
VERTICAL TURNING LATHE		
17	Z Movement : 650mm Chuck Size: 450mm	1
MILLING MACHINE		
18	Bed size: (L XW)1000mm x 250mm	1
19	Travel length (X,Y,Z):1000mm,Y 450, Z 300mm	1
CONVENTIONAL CYLINDRICAL GRINDING		
20	Between center: 550mm / Wheel diameter:300mm	1
21	Between center :1000mm / Wheel diameter:610mm	1
CNC GRINDING MACHINE		
22	Wheel diameter: 500mm / Travel length :300mm	1

S no	Process	Tolerance
1	shaft runout	0.010mm
2	Shaft total runout	0.015mm
3	Shaft cylindricity	0.015mm
4	Grinding tolerance	±/- 0.005mm
5	Keyway symmetry	0.03mm
6	PCD-Position tolerance	0.025mm
7	concentricity	0.020mm
8	Bore dimension tolerance	0.015mm
9	surface Ra value on a block	0.8min
10	surface Ra value on shaft	0.8min
11	Circuilarity	0.010mm
12	Perpendicularity	0.020mm

”OUR
TOLERANCE
ACHIEVABLE”



"OFFERING PRECISION MANUFACTURING SOLUTIONS AND INCREASING EFFICIENCIES ACROSS THE GLOBE"

INDIA | NEW ZEALAND | AMERICAS | MIDDLE
EAST | ITALY | UNITED KINGDOM

AQUA FLOW

*2/189-C, Karayampalayam Road,
Mylampatti Post, Coimbatore 641 062 INDIA*

Email: info@aquacnc.com

Tel: +91-422-262-9801
Tel: +91-822-058-9955

